



Bournemouth, Christchurch and Poole
Application to vary a premises licence
Licensing Act 2003

For help contact
licensing@bcpcouncil.gov.uk
 Telephone: 01202 123789

* required information

Section 1 of 18

You can save the form at any time and resume it later. You do not need to be logged in when you resume.

| | | |
|--|----------------------|--|
| System reference | Not Currently In Use | This is the unique reference for this application generated by the system. |
| Your reference | SDG/MAC614/5 | You can put what you want here to help you track applications if you make lots of them. It is passed to the authority. |
| Are you an agent acting on behalf of the applicant? <input type="radio"/> Yes <input checked="" type="radio"/> No | | Put "no" if you are applying on your own behalf or on behalf of a business you own or work for. |

Applicant Details

| | | |
|---|------------------|-----------------------|
| * First name | MACEMADE LIMITED | |
| * Family name | MACEMADE LIMITED | |
| * E-mail | [REDACTED] | |
| Main telephone number | | Include country code. |
| Other telephone number | | |
| <input type="checkbox"/> Indicate here if you would prefer not to be contacted by telephone | | |

Are you:

- ☒ Applying as a business or organisation, including as a sole trader
☐ Applying as an individual

A sole trader is a business owned by one person without any special legal structure. Applying as an individual means you are applying so you can be employed, or for some other personal reason, such as following a hobby.

Applicant Business

| | | |
|---|---|---|
| Is your business registered in the UK with Companies House? | <input checked="" type="radio"/> Yes <input type="radio"/> No | Note: completing the Applicant Business section is optional in this form. |
| Registration number | 3479536 | |
| Business name | MACEMADE LIMITED | If your business is registered, use its registered name. |
| VAT number | <div style="border: 1px solid black; padding: 2px; display: inline-block;">GB</div> <div style="border: 1px solid black; padding: 2px; display: inline-block; width: 100px;"></div> | Put "none" if you are not registered for VAT. |
| Legal status | Private Limited Company | |

Continued from previous page...

Your position in the business

Home country

The country where the headquarters of your business is located.

Registered Address

Address registered with Companies House.

Building number or name

Street

District

City or town

County or administrative area

Postcode

Country

Section 2 of 18

APPLICATION DETAILS

This application cannot be used to vary the licence so as to extend the period for which the licence has effect or to vary substantially the premises to which it relates. If you wish to make that type of change to the premises licence, you should make a new premises licence application under section 17 of the Licensing Act 2003.

I/we, as named in section 1, being the premises licence holder, apply to vary a premises licence under section 34 of the Licensing Act 2003 for the premises described in section 2 below.

* Premises Licence Number

Are you able to provide a postal address, OS map reference or description of the premises?

☒ Address ☐ OS map reference ☐ Description

Postal Address Of Premises

Building number or name

Street

District

City or town

County or administrative area

Postcode

Country

Premises Contact Details

Telephone number

Continued from previous page...

Non-domestic rateable
value of premises (£)

0

Section 3 of 18

VARIATION

Do you want the proposed
variation to have effect as
soon as possible?

☒ Yes

☐ No

Do you want the proposed variation to have effect in relation to the
introduction of the late night levy?

☐ Yes

☒ No

You do not have to pay a fee if the only
purpose of the variation for which you are
applying is to avoid becoming liable to the
late night levy.

If your proposed variation
would mean that 5,000 or
more people are expected to
attend the premises at any
one time, state the number
expected to attend

Describe Briefly The Nature Of The Proposed Variation

Describe the premises. For example the type of premises, its general situation and layout and any other information which could be relevant to the licensing objectives. Where your application includes off-supplies of alcohol and you intend to provide a place for consumption of these off-supplies, you must include a description of where the place will be and its proximity to the premises.

Beach side restaurant and bar operation at Solent Promenade. Proposed alterations to layout of premises to provide refreshment facilities on the beach and promenade area, to include on and off sales as per existing Premises Licence held by the former premises, Bistro on the Beach.

Section 4 of 18

PROVISION OF PLAYS

[See guidance on regulated entertainment](#)

Will the schedule to provide plays be subject to change if this application to
vary is successful?

☐ Yes

☒ No

Section 5 of 18

PROVISION OF FILMS

[See guidance on regulated entertainment](#)

Will the schedule to provide films be subject to change if this application to
vary is successful?

☐ Yes

☒ No

Section 6 of 18

PROVISION OF INDOOR SPORTING EVENTS

Continued from previous page...

[See guidance on regulated entertainment](#)

Will the schedule to provide indoor sporting events be subject to change if this application to vary is successful?

☐ Yes ☒ No

Section 7 of 18

PROVISION OF BOXING OR WRESTLING ENTERTAINMENTS

[See guidance on regulated entertainment](#)

Will the schedule to provide boxing or wrestling entertainments be subject to change if this application to vary is successful?

☐ Yes ☒ No

Section 8 of 18

PROVISION OF LIVE MUSIC

[See guidance on regulated entertainment](#)

Will the schedule to provide live music be subject to change if this application to vary is successful?

☐ Yes ☒ No

Section 9 of 18

PROVISION OF RECORDED MUSIC

[See guidance on regulated entertainment](#)

Will the schedule to provide recorded music be subject to change if this application to vary is successful?

☐ Yes ☒ No

Section 10 of 18

PROVISION OF PERFORMANCES OF DANCE

[See guidance on regulated entertainment](#)

Will the schedule to provide performances of dance be subject to change if this application to vary is successful?

☐ Yes ☒ No

Section 11 of 18

PROVISION OF ANYTHING OF A SIMILAR DESCRIPTION TO LIVE MUSIC, RECORDED MUSIC OR PERFORMANCES OF DANCE

[See guidance on regulated entertainment](#)

Will the schedule to provide anything similar to live music, recorded music or performances of dance be subject to change if this application to vary is successful?

☐ Yes ☒ No

Section 12 of 18

PROVISION OF LATE NIGHT REFRESHMENT

Continued from previous page...

Will the schedule to provide late night refreshment be subject to change if this application to vary is successful?

☐ Yes ☒ No

Section 13 of 18

SUPPLY OF ALCOHOL

Will the schedule to supply alcohol be subject to change if this application to vary is successful?

☐ Yes ☒ No

Section 14 of 18

ADULT ENTERTAINMENT

Highlight any adult entertainment or services, activities, or other entertainment or matters ancillary to the use of the premises that may give rise to concern in respect of children.

Provide information about anything intended to occur at the premises or ancillary to the use of the premises which may give rise to concern in respect of children, regardless of whether you intend children to have access to the premises, for example (but not exclusively) nudity or semi-nudity, films for restricted age groups etc gambling machines etc.

NONE

Section 15 of 18

HOURS PREMISES ARE OPEN TO THE PUBLIC

Standard Days And Timings

MONDAY

Start

End

Start

End

Provide timings in 24 hour clock (e.g., 16:00) and only give details for the days of the week when you intend the premises to be used for the activity.

TUESDAY

Start

End

Start

End

WEDNESDAY

Start

End

Start

End

THURSDAY

Start

End

Start

End

FRIDAY

Start

End

Start

End

Continued from previous page...

SATURDAY

Start End

Start End

SUNDAY

Start End

Start End

State any seasonal variations.

For example (but not exclusively) where the activity will occur on additional days during the summer months.

Non standard timings. Where you intend to use the premises to be open to the members and guests at different times from those listed above, list below.

For example (but not exclusively), where you wish the activity to go on longer on a particular day e.g. Christmas Eve.

New Year's Eve from the start of permitted hours to end of permitted hours on 1st January in each year

Identify those conditions currently imposed on the licence which you believe could be removed as a consequence of the proposed variation you are seeking.

Variation (not removal) of condition 3.1 to read:
Sales of alcohol for consumption off the premises shall only be permitted between 10:00 hours and 21.30 hours on Mondays to Saturdays inclusive, between 12:00 hours and 21.30 hours on Sundays and Good Friday and from 12.00 hours to 15.00 hours and 19.00 hours to 21.30 hours on Christmas Day

- ☐ I have enclosed the premises licence
- ☐ I have enclosed the relevant part of the premises licence

Reasons why I have failed to enclose the premises licence or relevant part of premises licence.

Premises Licence provided in electronic format only

Section 16 of 18

LICENSING OBJECTIVES

Describe the steps you intend to take to promote the four licensing objectives:

a) General – all four licensing objectives (b,c,d,e)

List here steps you will take to promote all four licensing objectives together.

Continued from previous page...

This variation application is made primarily to vary the layout of the premises and accordingly it is considered that the conditions in existence on the Premises Licence are sufficient and appropriate for the premises.

However, in respect of variation of condition 3.1 the following conditions are offered:

Off sales:

A maximum of six alcoholic drinks may be purchased at any one time per customer.

Wine to be sold by the glass

b) The prevention of crime and disorder

See comments above

c) Public safety

See comments above

d) The prevention of public nuisance

See comments above

e) The protection of children from harm

See comments above

Section 17 of 18

NOTES ON REGULATED ENTERTAINMENT

Continued from previous page...

In terms of specific **regulated entertainments** please note that:

- Plays: no licence is required for performances between 08:00 and 23:00 on any day, provided that the audience does not exceed 500.
- Films: no licence is required for 'not-for-profit' film exhibition held in community premises between 08:00 and 23:00 on any day provided that the audience does not exceed 500 and the organiser (a) gets consent to the screening from a person who is responsible for the premises; and (b) ensures that each such screening abides by age classification ratings.
- Indoor sporting events: no licence is required for performances between 08:00 and 23:00 on any day, provided that the audience does not exceed 1000.
- Boxing or Wrestling Entertainment: no licence is required for a contest, exhibition or display of Greco-Roman wrestling, or freestyle wrestling between 08:00 and 23:00 on any day, provided that the audience does not exceed 1000. Combined fighting sports – defined as a contest, exhibition or display which combines boxing or wrestling with one or more martial arts – are licensable as a boxing or wrestling entertainment rather than an indoor sporting event.
- Live music: no licence permission is required for:
 - o a performance of unamplified live music between 08:00 and 23:00 on any day, on any premises.
 - o a performance of amplified live music between 08:00 and 23:00 on any day on premises authorised to sell alcohol for consumption on those premises, provided that the audience does not exceed 500.
 - o a performance of amplified live music between 08:00 and 23:00 on any day, in a workplace that is not licensed to sell alcohol on those premises, provided that the audience does not exceed 500.
 - o a performance of amplified live music between 08:00 and 23:00 on any day, in a church hall, village hall, community hall, or other similar community premises, that is not licensed by a premises licence to sell alcohol, provided that (a) the audience does not exceed 500, and (b) the organiser gets consent for the performance from a person who is responsible for the premises.
 - o a performance of amplified live music between 08:00 and 23:00 on any day, at the non-residential premises of (i) a local authority, or (ii) a school, or (iii) a hospital, provided that (a) the audience does not exceed 500, and (b) the organiser gets consent for the performance on the relevant premises from: (i) the local authority concerned, or (ii) the school or (iii) the health care provider for the hospital.
- Recorded Music: no licence permission is required for:
 - o any playing of recorded music between 08:00 and 23:00 on any day on premises authorised to sell alcohol for consumption on those premises, provided that the audience does not exceed 500.
 - o any playing of recorded music between 08:00 and 23:00 on any day, in a church hall, village hall, community hall, or other similar community premises, that is not licensed by a premises licence to sell alcohol, provided that (a) the audience does not exceed 500, and (b) the organiser gets consent for the performance from a person who is responsible for the premises.
 - o any playing of recorded music between 08:00 and 23:00 on any day, at the non-residential premises of (i) a local authority, or (ii) a school, or (iii) a hospital, provided that (a) the audience does not exceed 500, and (b) the organiser gets consent for the performance on the relevant premises from: (i) the local authority concerned, or (ii) the school proprietor or (iii) the health care provider for the hospital.

Continued from previous page...

- Dance: no licence is required for performances between 08.00 and 23.00 on any day, provided that the audience does not exceed 500. However, a performance which amounts to adult entertainment remains licensable.
- Cross activity exemptions: no licence is required between 08.00 and 23.00 on any day, with no limit on audience size for:
 - o any entertainment taking place on the premises of the local authority where the entertainment is provided by or on behalf of the local authority;
 - o any entertainment taking place on the hospital premises of the health care provider where the entertainment is provided by or on behalf of the health care provider;
 - o any entertainment taking place on the premises of the school where the entertainment is provided by or on behalf of the school proprietor; and
 - o any entertainment (excluding films and a boxing or wrestling entertainment) taking place at a travelling circus, provided that (a) it takes place within a moveable structure that accommodates the audience, and (b) that the travelling circus has not been located on the same site for more than 28 consecutive days.

Section 18 of 18

PAYMENT DETAILS

This fee must be paid to the authority. If you complete the application online, you must pay it by debit or credit card. Refer to Borough of Poole website: <https://www.poole.gov.uk/business-and-consumers/licences-and-street-trading/licensing-act-2003/fees-for-licensing-act-2003/> Or search on: www.poole.gov.uk/business/licences

* Fee amount (£)

20.00

DECLARATION

* I understand it is an offence, liable on summary conviction to a fine not exceeding level 5 on the standard scale, under section 158 of the Licensing Act 2003, to make a false statement in or in connection with this application.

* I understand that I must now advertise my application.

* I understand that if I do not comply with the requirements my application will be rejected.

☒ Ticking this box indicates you have read and understood the above declaration

This section should be completed by the applicant, unless you answered "Yes" to the question "Are you an agent acting on behalf of the applicant?"

* Full name

Trethowans LLP

* Capacity

Solicitors and Authorised Agents

* Date

28

/

06

/

2022

dd

mm

yyyy

Add another signatory

Once you're finished you need to do the following:

1. Save this form to your computer by clicking file/save as...

2. Go back to <https://www.gov.uk/apply-for-a-licence/premises-licence/bournemouth-christchurch-poole/change-1> to upload this file and continue with your application.

Don't forget to make sure you have all your supporting documentation to hand.

Continued from previous page...

IT IS AN OFFENCE, UNDER SECTION 158 OF THE LICENSING ACT 2003, TO MAKE A FALSE STATEMENT IN OR IN CONNECTION WITH THIS APPLICATION. THOSE WHO MAKE A FALSE STATEMENT MAY BE LIABLE ON SUMMARY CONVICTION TO A FINE OF ANY AMOUNT.

OFFICE USE ONLY

| | |
|----------------------------|---|
| Applicant reference number | <input type="text" value="SDG/MAC614/5"/> |
| Fee paid | <input type="text"/> |
| Payment provider reference | <input type="text"/> |
| ELMS Payment Reference | <input type="text"/> |
| Payment status | <input type="text"/> |
| Payment authorisation code | <input type="text"/> |
| Payment authorisation date | <input type="text"/> |
| Date and time submitted | <input type="text"/> |
| Approval deadline | <input type="text"/> |
| Error message | <input type="text"/> |
| Is Digitally signed | <input type="checkbox"/> |

[1](#) [2](#) [3](#) [4](#) [5](#) [6](#) [7](#) [8](#) [9](#) [10](#) [11](#) [12](#) [13](#) [14](#) [15](#) [16](#) [17](#) [18](#) [Next >](#)

This drawing is copyright and the property of DNVNA Ltd. It may not be copied, reproduced or altered in any way without the written authority. Do not scale from this drawing, work to figured dimensions. All dimensions to be checked on site and any discrepancies reported to the Architect immediately. All structural and specialist sub-elements/components etc., including cladding, are to be approved by the Consulting Engineer or Specialist Contractor.

DESIGNERS RISK ASSESSMENT:
HEALTH AND SAFETY
THE CONSTRUCTION DESIGN AND
MANAGEMENT REGULATIONS 2007

Building Products and Construction Education
 Hazards

The proposed works are designed as a well established method of construction, which can be carried out by a competent contractor. However, the contractor had any area of concern he must advise the Designer immediately in order that appropriate action can be taken.

THESE CHANGES ARE PRELIMINARY ONLY AND THE INTENDED DETAILS ARE NOT COMPLETE. THESE ARE NOT FOR CONSTRUCTION PURPOSES.

428

Continued from p. 427

 University of Illinois Chicago
1610 East Lake Street
Chicago, IL 60607-7199
Tel: 312.996.3000 | Email: info@uic.edu

Assets covered by Emergency Lending

896 *Reviews*

 Fire Extinguisher Location
(to be specified by Specialist)

Free Download

Example Result

NOTE: This test should be performed first for ethylene glycol only. Check with your local law enforcement for any regulations. Do not dispose of test results.

Specialty: *See* **Primary Care**

8
 9
 10
 11
 12
 13
 14
 15
 16
 17
 18
 19
 20
 21
 22
 23
 24
 25
 26
 27
 28
 29
 30
 31
 32
 33
 34
 35
 36
 37
 38
 39
 40
 41
 42
 43
 44
 45
 46
 47
 48
 49
 50
 51
 52
 53
 54
 55
 56
 57
 58
 59
 60
 61
 62
 63
 64
 65
 66
 67
 68
 69
 70
 71
 72
 73
 74
 75
 76
 77
 78
 79
 80
 81
 82
 83
 84
 85
 86
 87
 88
 89
 90
 91
 92
 93
 94
 95
 96
 97
 98
 99
 100
 101
 102
 103
 104
 105
 106
 107
 108
 109
 110
 111
 112
 113
 114
 115
 116
 117
 118
 119
 120
 121
 122
 123
 124
 125
 126
 127
 128
 129
 130
 131
 132
 133
 134
 135
 136
 137
 138
 139
 140
 141
 142
 143
 144
 145
 146
 147
 148
 149
 150
 151
 152
 153
 154
 155
 156
 157
 158
 159
 160
 161
 162
 163
 164
 165
 166
 167
 168
 169
 170
 171
 172
 173
 174
 175
 176
 177
 178
 179
 180
 181
 182
 183
 184
 185
 186
 187
 188
 189
 190
 191
 192
 193
 194
 195
 196
 197
 198
 199
 200
 201
 202
 203
 204
 205
 206
 207
 208
 209
 210
 211
 212
 213
 214
 215
 216
 217
 218
 219
 220
 221
 222
 223
 224
 225
 226
 227
 228
 229
 230
 231
 232
 233
 234
 235
 236
 237
 238
 239
 240
 241
 242
 243
 244
 245
 246
 247
 248
 249
 250
 251
 252
 253
 254
 255
 256
 257
 258
 259
 260
 261
 262
 263
 264
 265
 266
 267
 268
 269
 270
 271
 272
 273
 274
 275
 276
 277
 278
 279
 280
 281
 282
 283
 284
 285
 286
 287
 288
 289
 290
 291
 292
 293
 294
 295
 296
 297
 298
 299
 300
 301
 302
 303
 304
 305
 306
 307
 308
 309
 310
 311
 312
 313
 314
 315
 316
 317
 318
 319
 320
 321
 322
 323
 324
 325
 326
 327
 328
 329
 330
 331
 332
 333
 334
 335
 336
 337
 338
 339
 340
 341
 342
 343
 344
 345
 346
 347
 348
 349
 350
 351
 352
 353
 354
 355
 356
 357
 358
 359
 360
 361
 362
 363
 364
 365
 366
 367
 368
 369
 370
 371
 372
 373
 374
 375
 376
 377
 378
 379
 380
 381
 382
 383
 384
 385
 386
 387
 388
 389
 390
 391
 392
 393
 394
 395
 396
 397
 398
 399
 400
 401
 402
 403
 404
 405
 406
 407
 408
 409
 410
 411
 412
 413
 414
 415
 416
 417
 418
 419
 420
 421
 422
 423
 424
 425
 426
 427
 428
 429
 430
 431
 432
 433
 434
 435
 436
 437
 438
 439
 440
 441
 442
 443
 444
 445
 446
 447
 448
 449
 450
 451
 452
 453
 454
 455
 456
 457
 458
 459
 460
 461
 462
 463
 464
 465
 466
 467
 468
 469
 470
 471
 472
 473
 474
 475
 476
 477
 478
 479
 480
 481
 482
 483
 484
 485
 486
 487
 488
 489
 490
 491
 492
 493
 494
 495
 496
 497
 498
 499
 500
 501
 502
 503
 504
 505
 506
 507
 508
 509
 510
 511
 512
 513
 514
 515
 516
 517
 518
 519
 520
 521
 522
 523
 524
 525
 526
 527
 528
 529
 530
 5

7 Burnside Road
West Parley
Frimley
Surrey

| Chart | e. Name |
|-----------|-----------|
| Chart 1 | Chart 1 |
| Chart 2 | Chart 2 |
| Chart 3 | Chart 3 |
| Chart 4 | Chart 4 |
| Chart 5 | Chart 5 |
| Chart 6 | Chart 6 |
| Chart 7 | Chart 7 |
| Chart 8 | Chart 8 |
| Chart 9 | Chart 9 |
| Chart 10 | Chart 10 |
| Chart 11 | Chart 11 |
| Chart 12 | Chart 12 |
| Chart 13 | Chart 13 |
| Chart 14 | Chart 14 |
| Chart 15 | Chart 15 |
| Chart 16 | Chart 16 |
| Chart 17 | Chart 17 |
| Chart 18 | Chart 18 |
| Chart 19 | Chart 19 |
| Chart 20 | Chart 20 |
| Chart 21 | Chart 21 |
| Chart 22 | Chart 22 |
| Chart 23 | Chart 23 |
| Chart 24 | Chart 24 |
| Chart 25 | Chart 25 |
| Chart 26 | Chart 26 |
| Chart 27 | Chart 27 |
| Chart 28 | Chart 28 |
| Chart 29 | Chart 29 |
| Chart 30 | Chart 30 |
| Chart 31 | Chart 31 |
| Chart 32 | Chart 32 |
| Chart 33 | Chart 33 |
| Chart 34 | Chart 34 |
| Chart 35 | Chart 35 |
| Chart 36 | Chart 36 |
| Chart 37 | Chart 37 |
| Chart 38 | Chart 38 |
| Chart 39 | Chart 39 |
| Chart 40 | Chart 40 |
| Chart 41 | Chart 41 |
| Chart 42 | Chart 42 |
| Chart 43 | Chart 43 |
| Chart 44 | Chart 44 |
| Chart 45 | Chart 45 |
| Chart 46 | Chart 46 |
| Chart 47 | Chart 47 |
| Chart 48 | Chart 48 |
| Chart 49 | Chart 49 |
| Chart 50 | Chart 50 |
| Chart 51 | Chart 51 |
| Chart 52 | Chart 52 |
| Chart 53 | Chart 53 |
| Chart 54 | Chart 54 |
| Chart 55 | Chart 55 |
| Chart 56 | Chart 56 |
| Chart 57 | Chart 57 |
| Chart 58 | Chart 58 |
| Chart 59 | Chart 59 |
| Chart 60 | Chart 60 |
| Chart 61 | Chart 61 |
| Chart 62 | Chart 62 |
| Chart 63 | Chart 63 |
| Chart 64 | Chart 64 |
| Chart 65 | Chart 65 |
| Chart 66 | Chart 66 |
| Chart 67 | Chart 67 |
| Chart 68 | Chart 68 |
| Chart 69 | Chart 69 |
| Chart 70 | Chart 70 |
| Chart 71 | Chart 71 |
| Chart 72 | Chart 72 |
| Chart 73 | Chart 73 |
| Chart 74 | Chart 74 |
| Chart 75 | Chart 75 |
| Chart 76 | Chart 76 |
| Chart 77 | Chart 77 |
| Chart 78 | Chart 78 |
| Chart 79 | Chart 79 |
| Chart 80 | Chart 80 |
| Chart 81 | Chart 81 |
| Chart 82 | Chart 82 |
| Chart 83 | Chart 83 |
| Chart 84 | Chart 84 |
| Chart 85 | Chart 85 |
| Chart 86 | Chart 86 |
| Chart 87 | Chart 87 |
| Chart 88 | Chart 88 |
| Chart 89 | Chart 89 |
| Chart 90 | Chart 90 |
| Chart 91 | Chart 91 |
| Chart 92 | Chart 92 |
| Chart 93 | Chart 93 |
| Chart 94 | Chart 94 |
| Chart 95 | Chart 95 |
| Chart 96 | Chart 96 |
| Chart 97 | Chart 97 |
| Chart 98 | Chart 98 |
| Chart 99 | Chart 99 |
| Chart 100 | Chart 100 |

Drawing Title: Proposed Fire Plan - General Fire
Job No: 2010004

April 2015
Vol. 35, No. 2

| | |
|------------|------------------|
| Source | As indicated (A) |
| Catalog No | 001 |
| Size | |

11

BMW

architects

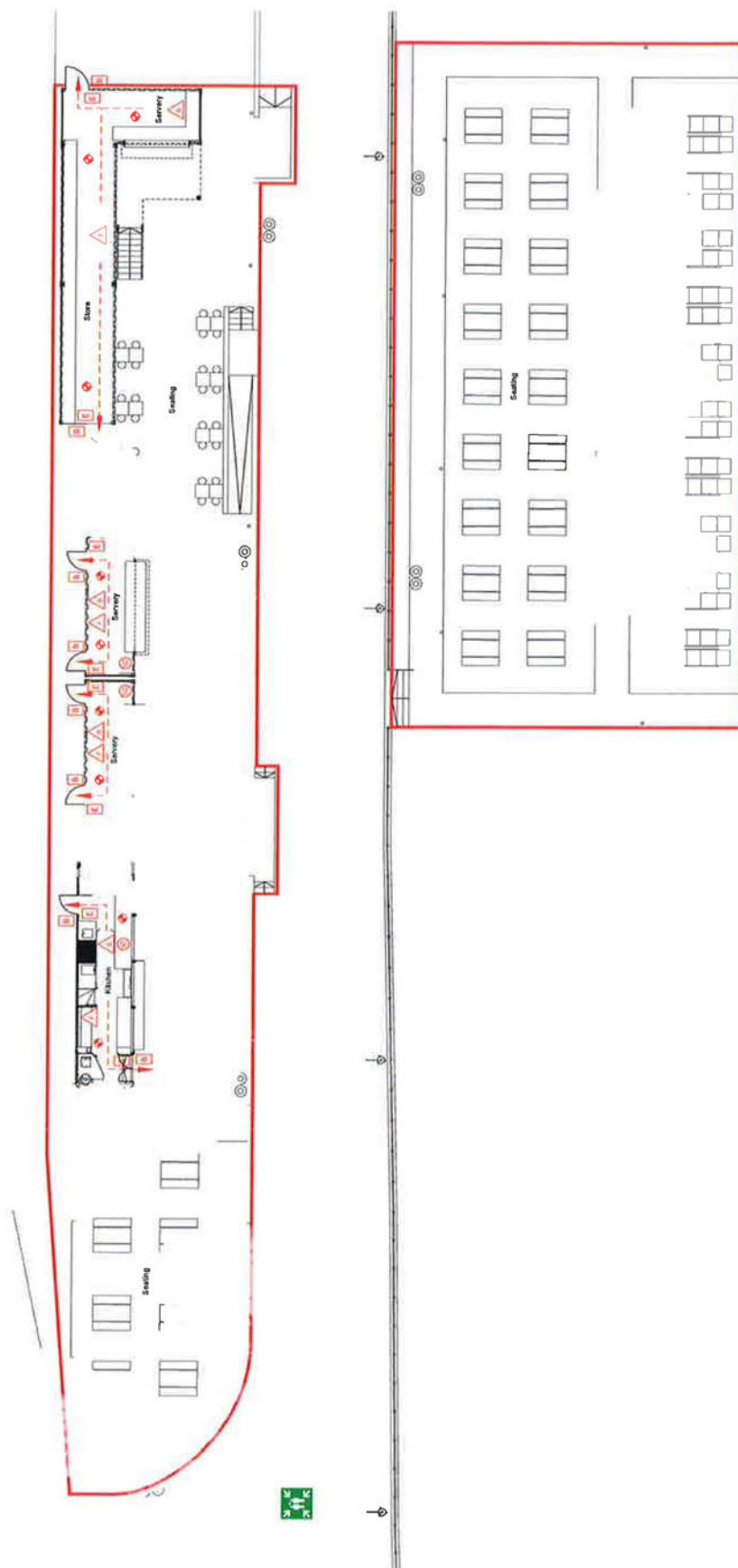

Proposed Fire Plan - Ground Floor

This drawing is copyright and the property of DHWA Ltd. It may not be copied, reproduced or altered in any way without the written authority. Do not scale from this drawing, work to figured dimensions. All dimensions to be checked on site and any discrepancies reported to the Architect immediately. All structural and specialist elements/components/details, including glazing, are to be approved by the Structural Engineer or Specialist Contractor.

**DELIVERING HIGH ASSESSMENT:
HEALTH AND SAFETY
THE CONSTRUCTION (DESIGN AND
MANAGEMENT) REGULATIONS 2009**

Construction hazards associated with Building Products and Construction products are not listed below and will be assumed to be controlled by the Architect/Contractor following good safety management and best practice procedures.

The proposed works are designed on a well established method of construction, which can be carried out by a competent contractor. However, should the contractor find any area of concern he must inform the designer immediately in order that appropriate action can be taken.

THESE DRAWINGS ARE PRELIMINARY ONLY AND THE INTENDED DETAILS ARE NOT COMPLETE. THESE ARE NOT FOR CONSTRUCTION PURPOSES.

5

 Combined Emergency/Built-in Lighting
in External Doors | Situated Externally

Illustrated Emergency Signage

Areas Covered by Emergency Lighting

© 2011 Pearson Education, Inc. All rights reserved. Printed in the United States of America. This publication is protected by copyright. Any unauthorized reproduction or distribution of this work in any form or by any means, electronic or mechanical, including photocopying, recording, or by any information storage and retrieval system, without permission in writing from the publisher is prohibited. All trademarks are the property of their respective owners.

 Five Distinguishing Locations
(To be visited for assessment)

Free Member

Damage Report

 Emergency Exit Sign

† This is based on information only. Only DASH® is the only diet that has been shown to lower the risk of stroke. Always consult your doctor before making any changes to your diet.

Downloaded from <http://ajphaphysiol.org/>

| | | | | | | | | | | | | | | | | | | | | | | | | | | | | | | | | | | | | | | | | | | | | | | | | | | | | | | | | | | | | | | | | | | | | | | | | | | | | | | | | | | | | | |
|----|----|----|----|----|----|----|----|----|----|----|----|----|----|----|----|----|----|----|----|----|----|----|----|----|----|----|----|----|----|----|----|----|----|----|----|----|----|----|----|----|----|----|----|----|----|----|----|----|----|----|----|----|----|----|----|----|----|----|----|----|----|----|----|----|----|----|----|----|----|----|----|----|----|----|----|----|----|----|----|----|----|----|----|----|-----|
| 15 | 16 | 17 | 18 | 19 | 20 | 21 | 22 | 23 | 24 | 25 | 26 | 27 | 28 | 29 | 30 | 31 | 32 | 33 | 34 | 35 | 36 | 37 | 38 | 39 | 40 | 41 | 42 | 43 | 44 | 45 | 46 | 47 | 48 | 49 | 50 | 51 | 52 | 53 | 54 | 55 | 56 | 57 | 58 | 59 | 60 | 61 | 62 | 63 | 64 | 65 | 66 | 67 | 68 | 69 | 70 | 71 | 72 | 73 | 74 | 75 | 76 | 77 | 78 | 79 | 80 | 81 | 82 | 83 | 84 | 85 | 86 | 87 | 88 | 89 | 90 | 91 | 92 | 93 | 94 | 95 | 96 | 97 | 98 | 99 | 100 |
|----|----|----|----|----|----|----|----|----|----|----|----|----|----|----|----|----|----|----|----|----|----|----|----|----|----|----|----|----|----|----|----|----|----|----|----|----|----|----|----|----|----|----|----|----|----|----|----|----|----|----|----|----|----|----|----|----|----|----|----|----|----|----|----|----|----|----|----|----|----|----|----|----|----|----|----|----|----|----|----|----|----|----|----|----|-----|

TABLE 1

Project: **Southmore High Life Code**7 Burnbrae Road
West Parry
Farnham
Dorset

| Client | # State | 8/1/03 8/31/03 |
|--------|---------|----------------|
| 1 | 1 | 1 |
| 2 | 2 | 2 |
| 3 | 3 | 3 |
| 4 | 4 | 4 |
| 5 | 5 | 5 |
| 6 | 6 | 6 |
| 7 | 7 | 7 |
| 8 | 8 | 8 |
| 9 | 9 | 9 |
| 10 | 10 | 10 |
| 11 | 11 | 11 |
| 12 | 12 | 12 |
| 13 | 13 | 13 |
| 14 | 14 | 14 |
| 15 | 15 | 15 |
| 16 | 16 | 16 |
| 17 | 17 | 17 |
| 18 | 18 | 18 |
| 19 | 19 | 19 |
| 20 | 20 | 20 |
| 21 | 21 | 21 |
| 22 | 22 | 22 |
| 23 | 23 | 23 |
| 24 | 24 | 24 |
| 25 | 25 | 25 |
| 26 | 26 | 26 |
| 27 | 27 | 27 |
| 28 | 28 | 28 |
| 29 | 29 | 29 |
| 30 | 30 | 30 |
| 31 | 31 | 31 |
| 32 | 32 | 32 |
| 33 | 33 | 33 |
| 34 | 34 | 34 |
| 35 | 35 | 35 |
| 36 | 36 | 36 |
| 37 | 37 | 37 |
| 38 | 38 | 38 |
| 39 | 39 | 39 |
| 40 | 40 | 40 |
| 41 | 41 | 41 |
| 42 | 42 | 42 |
| 43 | 43 | 43 |
| 44 | 44 | 44 |
| 45 | 45 | 45 |
| 46 | 46 | 46 |
| 47 | 47 | 47 |
| 48 | 48 | 48 |
| 49 | 49 | 49 |
| 50 | 50 | 50 |
| 51 | 51 | 51 |
| 52 | 52 | 52 |
| 53 | 53 | 53 |
| 54 | 54 | 54 |
| 55 | 55 | 55 |
| 56 | 56 | 56 |
| 57 | 57 | 57 |
| 58 | 58 | 58 |
| 59 | 59 | 59 |
| 60 | 60 | 60 |
| 61 | 61 | 61 |
| 62 | 62 | 62 |
| 63 | 63 | 63 |
| 64 | 64 | 64 |
| 65 | 65 | 65 |
| 66 | 66 | 66 |
| 67 | 67 | 67 |
| 68 | 68 | 68 |
| 69 | 69 | 69 |
| 70 | 70 | 70 |
| 71 | 71 | 71 |
| 72 | 72 | 72 |
| 73 | 73 | 73 |
| 74 | 74 | 74 |
| 75 | 75 | 75 |
| 76 | 76 | 76 |
| 77 | 77 | 77 |
| 78 | 78 | 78 |
| 79 | 79 | 79 |
| 80 | 80 | 80 |
| 81 | 81 | 81 |
| 82 | 82 | 82 |
| 83 | 83 | 83 |
| 84 | 84 | 84 |
| 85 | 85 | 85 |
| 86 | 86 | 86 |
| 87 | 87 | 87 |
| 88 | 88 | 88 |
| 89 | 89 | 89 |
| 90 | 90 | 90 |
| 91 | 91 | 91 |
| 92 | 92 | 92 |
| 93 | 93 | 93 |
| 94 | 94 | 94 |
| 95 | 95 | 95 |
| 96 | 96 | 96 |
| 97 | 97 | 97 |
| 98 | 98 | 98 |
| 99 | 99 | 99 |
| 100 | 100 | 100 |

| | |
|----------------|-----------------------------------|
| Ordering Title | Proposed Fire Alarm - First Floor |
| Job No. | 20-0214 |

| | |
|-------|----------|
| Drawn | AR / RM |
| Date | 10.05.16 |

Scale: As indicated @ A1
Drawing No: 002

PLATE 1

MD

architects

Proposed Fire Plan - First Floor
1-100